

Accessories  
BOS R-12  
miniature reflector, rectangular

Common Data

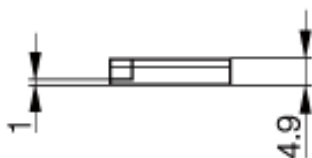

Usable with

for laser retroreflective

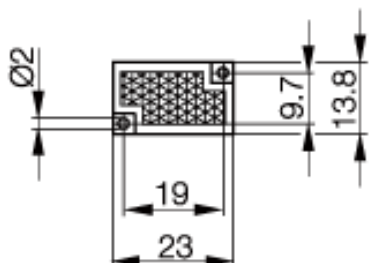

Mechanical Data

Measurements BxHxT or DxT

mm 23x13.8x4.9

Mounting

two M2 screws

PX1450

If not differently indicated,  
all values by IEC 947-5-2 (DIN EN60947-5-2)  
Specifications subject to change

Balluff GmbH  
Postfach 1160  
73761 Neuhausen  
Telefon (07158) 173-0  
Telefax (07158) 5010

06.02.2004 / Online-  
Productinformation

**BALLUFF**

